

9/9/2023 8:47:35 PM BIM 360://018133 Mono Jail018133_ARCH\MSTR_FC01_CENTRAL.rvt

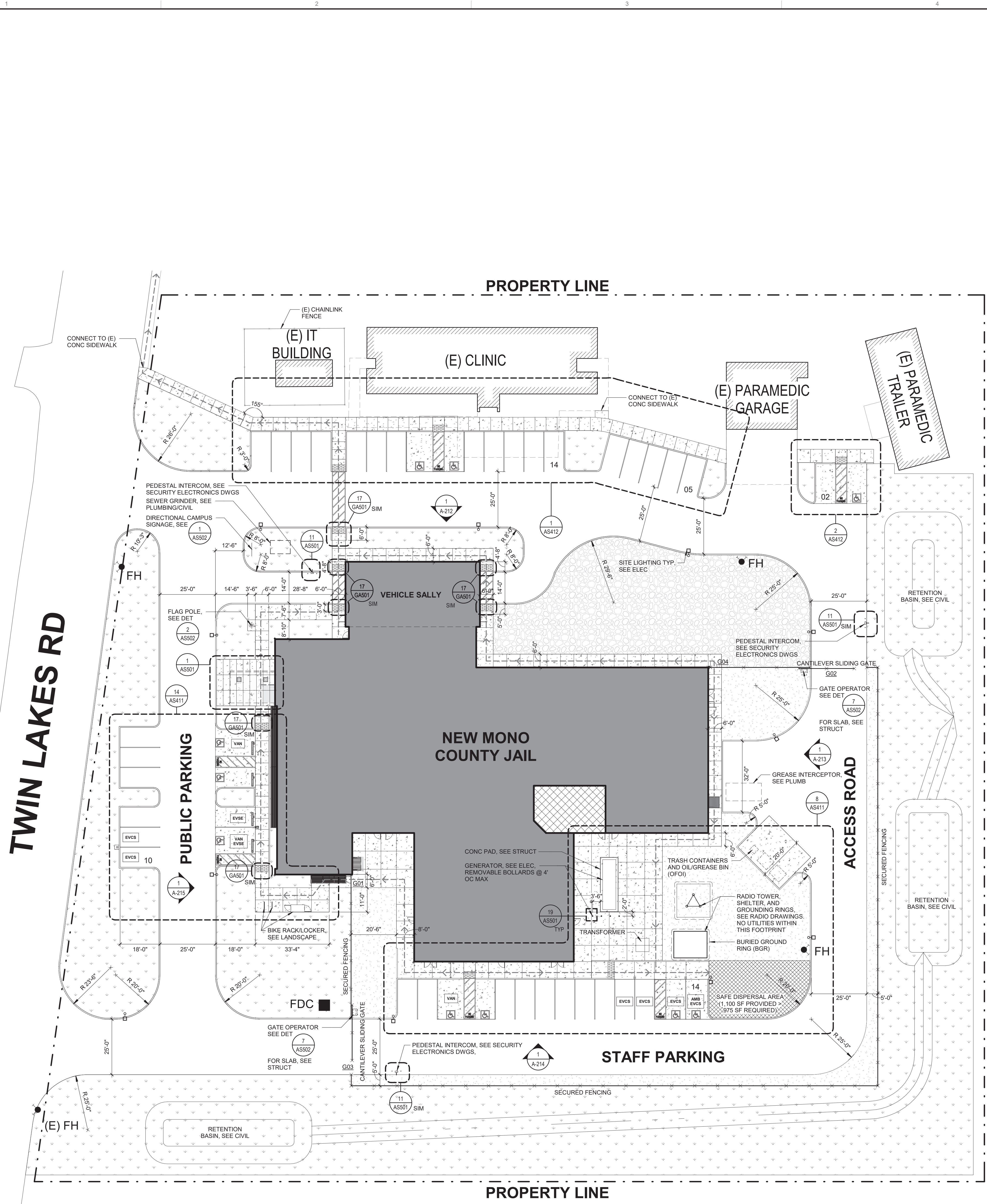

GENERAL NOTES

- FOR SYMBOLS LEGEND AND ARCHITECTURAL ABBREVIATIONS, SEE SHEET G-001.
- ALL DIMENSIONS ARE TO FACE OF STUD FACE OF CONCRETE MASONRY OR CENTERLINE OF COLUMN GRIDS, UNLESS NOTED OTHERWISE. CLEAR DIMENSIONS AT DOORS, ACCESSORIES, AND PLUMBING ARE TO FACE OF FINISH TYP.
- SEE CIVIL DRAWINGS FOR GRADING AND DRAINAGE AROUND THE BUILDING.
- SEE CIVIL AND LANDSCAPE DRAWINGS FOR DETAILS OF IMPROVED FLATWORK AREAS NOTED ON THESE SHEETS.
- COORDINATE UTILITY INFORMATION WITH CIVIL, LANDSCAPE, MECHANICAL, PLUMBING AND ELECTRICAL DRAWINGS.
- ALL ITEMS ARE CONSIDERED NEW UNLESS IDENTIFIED AS EXISTING, THESE NEW ITEMS SHALL BE INCLUDED IN THE CONTRACT UON.
- SEE LANDSCAPE DRAWINGS FOR WALKWAY JOINT DETAILS.
- CROSS-SLOPE OF NEW PAVING/WALKWAYS SHALL NOT EXCEED 1.5%. SLOPE ALONG THE PATH OF TRAVEL SHALL NOT EXCEED 5% UNLESS OTHERWISE NOTED.
- ALL EXTERIOR MASONRY SURFACES ARE TO RECEIVE ONE COAT OF WATER REPELLENT PRODUCT. SEE LEGEND BELOW FOR LOCATIONS WHERE A SECOND APPLICATION OF (ANTI-GRAFFITI) COATING IS REQUIRED ON THE BUILDING WALL SURFACES.

SITE LEGEND

	PROPOSED BUILDING		CONCRETE SIDE WALKS AND PADS, SEE CIVIL AND LANDSCAPE DRAWINGS
	(E) BUILDING		AC PAVING
	LANDSCAPING, SEE LANDSCAPE DRAWINGS		SECURITY WOVEN MESH
	DECOMPOSED GRANITE SURFACE, SEE LANDSCAPE DRAWINGS		SAFE DISPERSAL AREA
	CRUSHED DECORATIVE AGGREGATE SURFACE, SEE LANDSCAPE DRAWINGS		FH FIRE HYDRANT
	ACCESSIBLE PATH OF TRAVEL (BARRIER-FREE ACCESS ROUTE WITHOUT ANY ABRUPT LEVEL CHANGES EXCEEDING 1/2" IF BEVELED AT 1:2 MAX SLOPE OR VERTICAL LEVEL CHANGES NOT EXCEEDING 1/4" MAX AND AT LEAST 48" IN WIDTH. SURFACE IS STABLE, FIRM, AND SLIP RESISTANT. CROSS SLOPE DOES NOT EXCEED 1.5% AND SLOPE IN THE DIRECTION OF TRAVEL IS LESS THAN 5% UNLESS OTHERWISE INDICATED. ACCESSIBLE PATH OF TRAVEL SHALL BE MAINTAINED FREE OF OVERHANGING OBSTRUCTIONS TO 80" MINIMUM AND PROTRUDING OBJECTS GREATER THAN 4" PROJECTION FROM WALL BETWEEN 27" AND 80" ABOVE GRADE. SEE CIVIL DRAWINGS FOR SIDEWALK AND PAVED ROAD LOCATIONS, TYP.)		FDC FIRE DEPARTMENT CONNECTION

GATE SCHEDULE

GATE NO.	GATE TYP.	NO OF PANELS	HEIGHT	WIDTH	DETAIL	HARDWARE GROUP	COMMENTS
G01	SWING CHAINLINK	1	7'-0"	4'-0"	10 / ASS03	DH7	--
G02	SLIDING CHAINLINK	1	12'-0"	24'-0"	7 / ASS02	08	--
G03	SLIDING CHAINLINK	1	12'-0"	24'-0"	7 / ASS02	08	--
G04	SWING CHAINLINK	1	7'-0"	4'-0"	10 / ASS03	DH7	--

PARKING CALCULATIONS

ELECTRIC VEHICLE (EV) CHARGING PER CALGREEN TABLE 5.106.5.3.1

PARKING AREA	TOTAL NUMBER OF PARKING SPACES	NUMBER OF REQUIRED EV CAPABLE SPACES	NUMBER OF EVCS (EV CAPABLE SPACES PROVIDED WITH EVSE)
PUBLIC/STAFF	45	8	2

REQUIRED ACCESSIBLE PARKING SPACES PER TABLE 11B-208.2 AND SECTION 11B-208.2.4

PARKING AREA	TOTAL NUMBER OF PARKING SPACES	MINIMUM NUMBER OF REQUIRED ACCESSIBLE PARKING SPACE	MINIMUM NUMBER OF VAN ACCESSIBLE PARKING SPACES
PUBLIC	31	2	1
STAFF	14	1	1

ACCESSIBLE SPACES REQUIREMENTS PER CBC TABLE 11B-228.3.2.1 AND SECTION 11B-228.3.2 WITH SECTION 11B-812

PARKING AREA	TOTAL NUMBER OF EVCS AT A FACILITY	MINIMUM NUMBER OF EVCS REQUIRED TO COMPLY WITH SECTION 11B-812		
		VAN ACCESSIBLE	STANDARD ACCESSIBLE	AMBULATORY
PUBLIC/STAFF	26-50	1	1	1

ACTUAL PARKING COUNT

PARKING AREA	STANDARD SPACES	VAN ACCESSIBLE PARKING SPACES	STANDARD ACCESSIBLE PARKING SPACES	NUMBER OF REQUIRED EV CAPABLE SPACES	NUMBER OF EVCS (EV CAPABLE SPACES PROVIDED WITH EVSE)	TOTAL
PUBLIC	21	1	1	8	2	31
STAFF	9	1	0	4	0	14

CONSTRUCTION DOCUMENTS

MANAGEMENT
 LIONAKIS PROJECT NO: 018133
 CLIENT PROJECT NO: 018133
 COPYRIGHT: LIONAKIS 2022

TITLE

SITE PLAN

SHEET
AS101

V1

2025 Nineteenth Street
 Sacramento CA 95818
 P 916.658.1900
 www.lionakis.com

GOVMOTUS No.22-N-3854-CP-DR
 AGENCY
 CONSULTANT
 SEAL

PROJECT
MONO COUNTY NEW JAIL

221 TWIN LAKES RD
 BRIDGEPORT, CA 95317

CLIENT
 MONO COUNTY PUBLIC WORKS
 DEPARTMENT
 P.O. BOX 457, BRIDGEPORT, CA 95317

ISSUED	MARK	DATE	DESCRIPTION

1 SITE PLAN
 1" = 20'-0"

