

IF THIS SHEET IS NOT SEAL, IT IS A REPRODUCTION. SCALE ACCORDINGLY.

B:\A\200\091913\_Mono\_Jul10113\_ARCH\AS102\_ARCH\AS102\_ARCH.dwg

**1 SITE PLAN - LOGISTICS - PHASE 1**  
SCALE: 1"=20'-0"

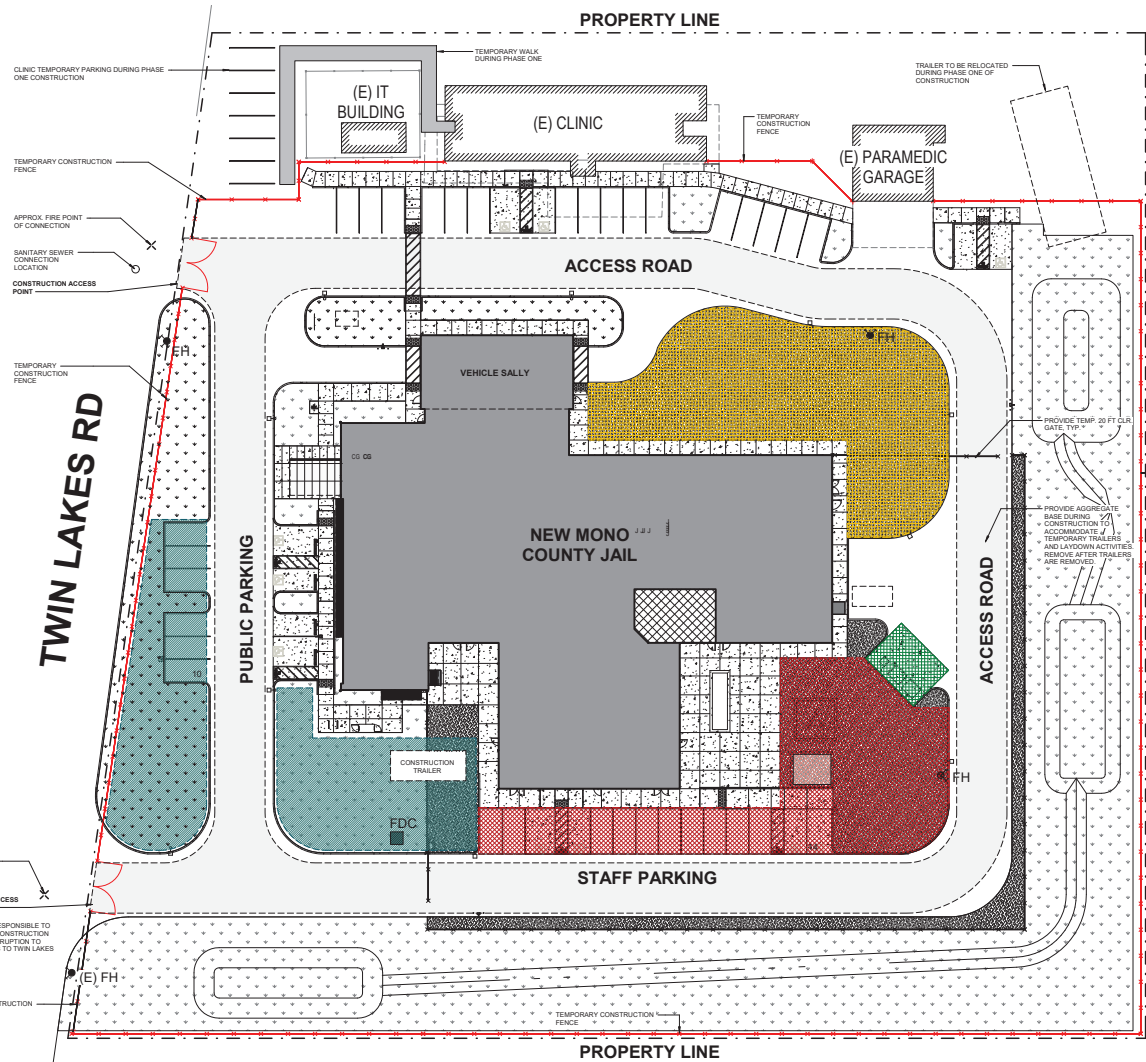

### SITE LOGISTICS LEGEND

	PROPOSED BUILDING		FIRE HYDRANT
	(E) BUILDING		FIRE DEPARTMENT CONNECTION
	PROPOSED CONSTRUCTION VEHICLE PARKING		PROPOSED TEMPORARY CONSTRUCTION FENCING
	PROPOSED JOB TRAILER LOCATION AND PARKING		PROPOSED REFUSE/RECYCLING CONTAINERS
	PROPOSED MATERIAL LAYDOWN/STAGING AREA		TEMPORARY WALK DURING PHASE ONE OF CONSTRUCTION
	FIRE APPARATUS ACCESS ROAD (REQUIRED PER 2019 TITLE 18, DIVISION 1, CHAPTER 1, SUBCHAPTER 1, ARTICLE 3.05(a))		
	REQUIRED ACCESS ROADS FROM BUILDING TO THE PUBLIC STREET SHALL BE ALL-WEATHER HARD-SURFACED (SUITABLE FOR USE BY FIRE APPARATUS) RIGHT-OF-WAY NOT LESS THAN 20 FT. IN WIDTH. SUCH RIGHT-OF-WAY SHALL BE UNOBSTRUCTED & MAINTAINED ONLY AS ACCESS TO THE PUBLIC STREET.		

- ### GENERAL NOTES
- REVIEWING OF TEMPORARY CONSTRUCTION AT LAYDOWN/STAGING AREAS**
- CONTRACTOR TO COORDINATE WITH OWNER AND UTILITY COMPANIES FOR TIE-IN OF TEMPORARY POWER, PHONE, AND WATER. THE PLANS TO TIE-IN THE TEMPORARY UTILITIES FROM A TEMPORARY POWER PANEL, WATER SOURCE, AND DATA CONNECTION THAT TIES INTO THE EXISTING UTILITY ON BAY AVENUE.
  - CONTRACTOR TO PROVIDE A MINIMUM OF 4" CLASS II AGGREGATE BASE WITH 90% COMPACTION OVER 3" OF 90% COMPACTED SUBGRADE AT LAYDOWN AND STAGING AREAS.
  - CONTRACTOR TO PROVIDE A MINIMUM OF 4" CLASS II AGGREGATE BASE WITH 90% COMPACTION OVER 4" OF COMPACTED SUBGRADE AT FIRE LANE AND DRIVEWAYS. THESE AREAS ARE TO BE MAINTAINED FOR THE DURATION OF CONSTRUCTION.
  - ALL STAGING AND PARKING AREAS TO BE CLEANED AND PREPARED TO BE DEVELOPED TO THEIR FINISHED DESIGN WHEN STAGING OF MAJOR BUILDING COMPONENTS HAS CONCLUDED.

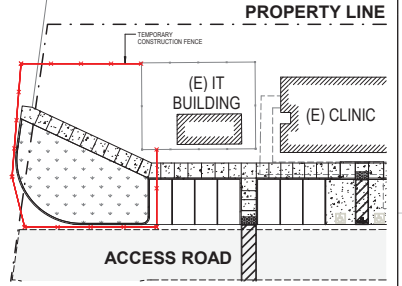

**2 SITE PLAN - LOGISTICS - PHASE 2**  
SCALE: 1"=20'-0"



MARK	DATE	DESCRIPTION